



**RECORD OF TITLE
UNDER LAND TRANSFER ACT 2017
CROSS LEASE
Search Copy**



R.W. Muir
Registrar-General
of Land

Identifier **416693**
Land Registration District **South Auckland**
Date Issued 20 August 2008

Prior References
SA34D/323 SA34D/324 SA34D/325

Estate Fee Simple - 1/3 share
Area 1193 square metres more or less
Legal Description Lot 13 Deposited Plan 6825
Registered Owners
Malone Pakimana Harris and Keiana Margaret Fatafehi Harris

Estate	Leasehold	Instrument	L 7913505.2
		Term	999 years commencing on 2.7.1985
Legal Description	Flat C Deposited Plan South Auckland 38828 and Garage C Deposited Plan 404812		

Registered Owners
Malone Pakimana Harris and Keiana Margaret Fatafehi Harris

Interests

H621616.1 Lease of Flat A DP South Auckland 38828 Term 999 years commencing on 2.7.1985 Composite CT SA34D/323 issued - 22.10.1985 (Affects Fee Simple)
H621616.2 Lease of Flat B Term 999 years commencing on 2.7.1985 Composite CT SA34D/324 issued - 22.10.1985 (Affects Fee Simple)
7913505.2 Lease of Flat C Deposited Plan South Auckland 38828 and Garage C Deposited Plan 404812 Term 999 years commencing on 2.7.1985 Composite CT 416693 issued - 20.8.2008 at 9:00 am (Affects Fee Simple)
11499112.3 Mortgage to (now) ASB Bank Limited - 30.7.2019 at 1:01 pm

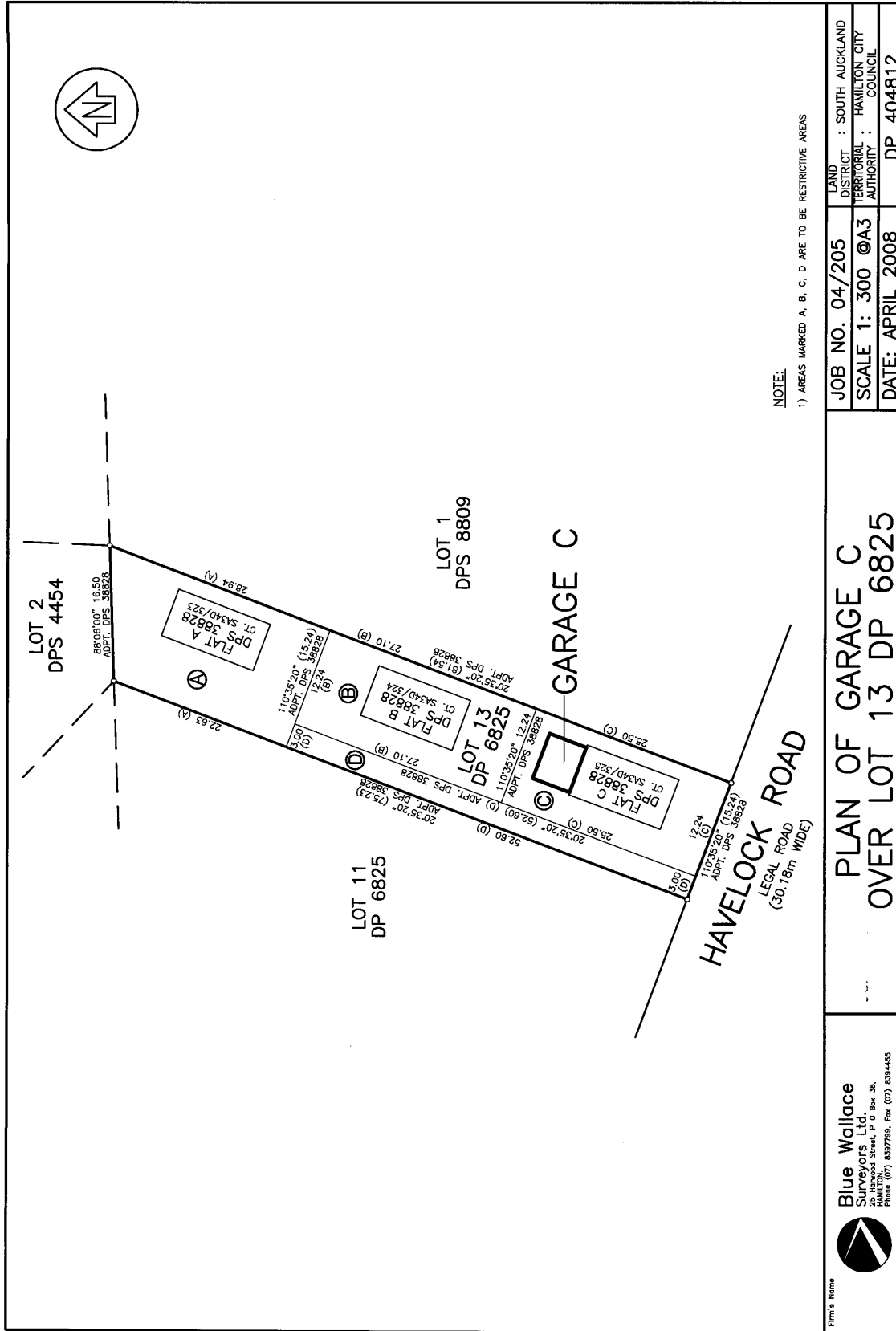

Firm's Name
Blue Wallace
 Surveyors Ltd.
 241-243 Broadway Street, P O Box 38,
 Hamilton, New Zealand
 Phone (07) 8397799, Fax (07) 8394455

**PLAN OF GARAGE C
 OVER LOT 13 DP 6825**